

PART LIST and DIAGRAM  
Pneumatic Airless Pump 25000 P - 16:1

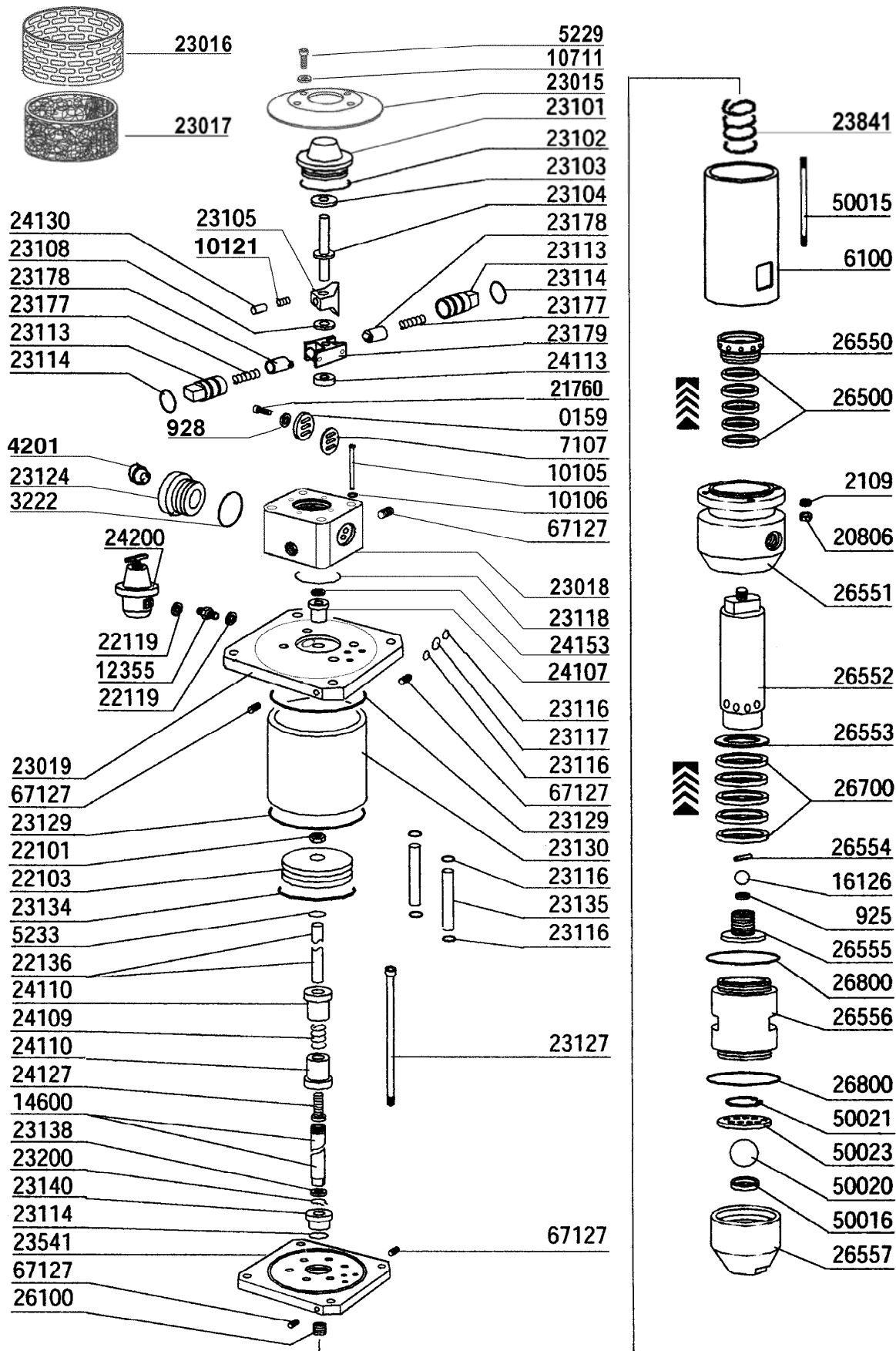

PART LIST and DIAGRAM  
Pneumatic Airless Pump 25000 P - 16:1

Ref.	Description	Q.ty	Ref.	Description	Q.ty
<b>25200</b>	<b><i>Pneumatic airless pump 25000 P - 16:1</i></b>				
000159	CAP	1	023541	LOWER FLANGE	1
000925	SEAT	1	023841	SAFETY SPRING	1
000928	WASHER, SUCTION VALVE	1	024107	SELF-LUBRICATING BUSH	1
002109	SCHNOOR WASHER	4	024109	SPRING	1
003222	O.R.	1	024110	UPPER GUIDE	2
004201	OIL LEVEL GLASS	1	024113	LOWER BUFFER	1
005229	FIXING BOLT	4	024127	BOLT	1
005233	WASHER SCHNOOR	1	024130	SPRING GUIDE	1
006100	AIR/PAINT SPACER	1	024153	LUBRORING	1
007107	GASKET	1	024200	PRES. REDUCER 3/8" CPL. WITH GAUGE	1
010105	BOLT	4	026100	CONNECTING BUSH	1
010106	WASHER SCHNOOR	4	026500	FIX UPPER PACKING	1
010121	SPRING	1	026550	FIXING RING NUT	1
010711	WASHER	4	026551	CENTRAL PUMPING BODY	1
012355	NIPPLE MM3/8"	1	026552	MATERIAL PISTON	1
014600	AIR PISTON SHAFT	1	026553	WASHER	1
016126	BALL dia.25 IN S.S.	1	026554	BALL STOP-PIN	1
020806	BOLT	4	026555	COMPRESSION VALVE BODY	1
021760	FIXING SCREW	2	026556	SLEEVE	1
022101	NUT	1	026557	SUCTION VALVE BODY	1
022103	AIR MOTOR PISTON	1	026700	LOWER SEALS MOBILE	1
022119	COPPER GASKET 3/8"	2	026800	OR, TEFLON	2
022136	PILOT VALVE ROD	1	050015	TIE-ROD M8, S.S.	4
023015	COVER, MOTOR SILENCER	1	050016	INLET VALVE BALL SEAT	1
023016	FILTER NET	1	050020	INLET VALVE BALL	1
023017	SILENCER	1	050021	SEEGER RING	1
023018	AIR CONTROL VALVE BODY	1	050023	BALL STOP COVER	1
023019	UPPER FLANGE	1	067127	CONICAL PLUG 1/4"	5
023101	COVER COMPLETE WITH BUSH	1			
023102	GASKET	1			
023103	UPPER BUFFER	1			
023104	PILOT SHAFT	1			
023105	AIR CONTROL VALVE SUPPORT	1			
023108	WASHER	1			
023113	PISTON BODY	2			
023114	GASKET	3			
023116	GASKET	6			
023117	GASKET	1			
023118	GASKET	1			
023124	AIR CLUTCH FLANGE	1			
023127	SOCKET SCREW	4			
023129	GASKET	2			
023130	AIR CYLINDER	1			
023134	LUBRORING	1			
023135	AIR CONNECTION TUBE	2			
023138	SEEGER	1			
023140	LOWER FLANGE BUSH	1			
023177	SPRING FOR REVERSAL KIT	2			
023178	REVERSAL KIT PISTON	2			
023179	REVERSAL CONTROL SYSTEM	1			
023200	RING	1			