

PART LIST and DIAGRAM
Pneumatic Airless Pump 25000 P - 6:1

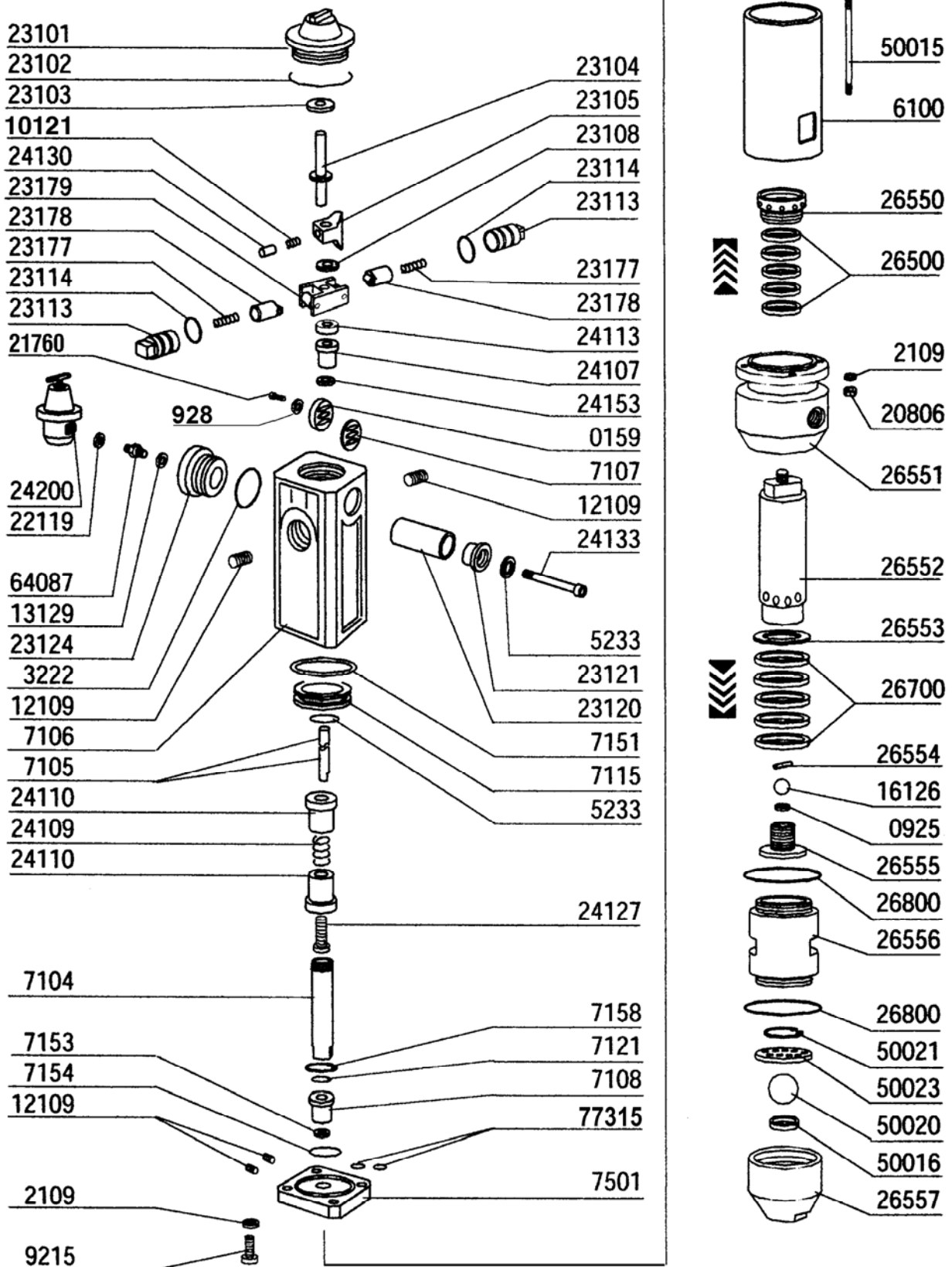

PART LIST and DIAGRAM
Pneumatic Airless Pump 25000 P - 6:1

Ref.	Description	Q.ty	Ref.	Description	Q.ty
25002	<i>Pneumatic airless pump 25000 P - 6:1</i>				
000159	CAP	1	024110	UPPER GUIDE	1
000925	SEAT	1	024113	LOWER BUFFER	1
000928	WASHER, SUCTION VALVE	1	024127	BOLT	1
002109	SCHNOOR WASHER	8	024130	SPRING GUIDE	1
003222	O.R.	1	024133	BOLT	1
005233	WASHER SCHNOOR	2	024153	LUBRORING	1
006100	AIR/PAINT SPACER	1	024200	PRESSURE REDUCER 3/8" COMPLETE WITH GAUG	1
006121	SPRING	1	026500	FIX UPPER PACKING	1
007104	SHAFT, AIR MOTOR 7000 P	1	026550	FIXING RING NUT - 6:1	1
007105	ROD	1	026551	CENTRAL PUMPING BODY - 6:1	1
007106	AIR CONTROL VALVE BODY	1	026552	MATERIAL PISTON - 6:1	1
007107	GASKET	1	026553	WASHER - 6:1	1
007108	BUSH IN TEFLON	1	026554	BALL STOP-PIN - 6:1	1
007115	AIR MOTOR PISTON	1	026555	COMPRESSION VALVE BODY - 6:1	1
007121	RING C.S.C.	1	026556	SLEEVE FOR 6:1	1
007151	LUBRORING	1	026557	SUCTION VALVE BODY FOR 6:1	1
007153	O.R. RING	1	026700	LOWER SEALS MOBILE - 6:1	1
007154	O.R. RING	1	026800	OR, TEFLON	1
007158	SEEGER RING	1	050015	TIE-ROD M8, S.S.	4
007501	AIR MOTOR FLANGE	1	050016	INLET VALVE BALL SEAT	1
009215	FIXING SCREW	1	050020	INLET VALVE BALL	1
012109	CONICAL PLUG 1/8"	4	050021	SEEGER RING	1
013129	COPPER GASKET 1/2"	1	050023	BALL STOP COVER	1
016126	BALL dia.25 IN S.S.	1	064087	NIPPLE M3/8" - M1/2" - S.S.	1
020806	BOLT	4	077315	OR RING	2
021760	FIXING SCREW	2			
022119	COPPER GASKET 3/8"	1			
023101	COVER COMPLETE WITH BUSH	1			
023102	GASKET	1			
023103	UPPER BUFFER	1			
023104	PILOT SHAFT	1			
023105	AIR CONTROL VALVE SUPPORT	1			
023108	WASHER	1			
023113	PISTON BODY	2			
023114	GASKET	2			
023120	SILENCER	1			
023121	SILENCER FIXING CAP	1			
023124	AIR CLUTCH FLANGE	1			
023177	SPRING FOR REVERSAL KIT	1			
023178	REVERSAL KIT PISTON	2			
023179	REVERSAL CONTROL SYSTEM	1			
024107	SELF-LUBRICATING BUSH	1			
024109	SPRING	1			