

PART LIST AND DIAGRAM  
Double diaphragm pump BOXER 24

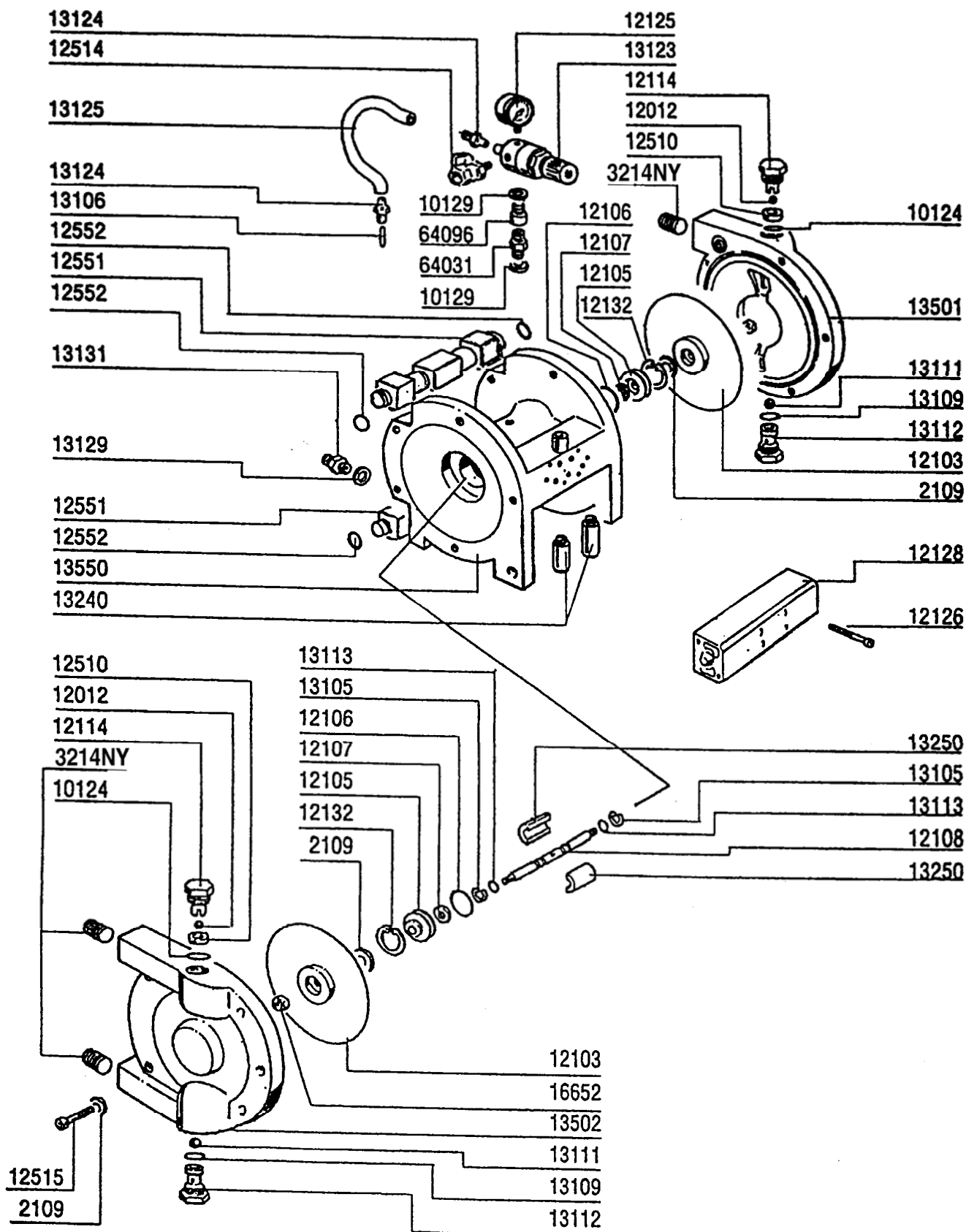

PART LIST AND DIAGRAM  
**Double diaphragm pump BOXER 24**

Ref.	Description	Q.ty	Ref.	Description	Q.ty
<b>13000</b>	<b>Double diaphragm pump BOXER 24</b>				
002109	SCHNOOR WASHER	12	013112	SUCTION VALVE BODY	2
003130	INLET SEAL	1	013113	O.R. RING	2
003214	PLUG	4	013123	PRESSURE REDUCER 1/4"	1
010124	BALL SEAT GASKET	2	013124	RAPID ADAPTOR M1/8" dia.2-4	1
010129	COPPER SEAL	2	013125	RILSAN HOSE dia.4 cm.10	1
012011	BALL dia.11, S.S.	1	013129	COPPER GASKET 1/2"	1
012012	BALL dia.11, NYLON	2	013131	NIPPLE M 1/2" M 3/4" - S.S.	1
012103	DIAPHRAGM	2	013240	SILENCER 1/4"	2
012105	SHAFT GUIDE	2	013250	HALF BEARING	2
012106	O.R. RING	2	013501	PLASTIC HEAD, RIGHT	1
012107	SEAL RING	2	013502	PLASTIC HEAD, LEFT	1
012108	SHAFT	1	013550	PUMP HOUSING	1
012114	COMPRESSION VALVE PLUG	2	016652	SELF LOCKING NUT M8	2
012125	GAUGE BOXER	1	064031	NIPPLE S.S. MM1/4"	1
012126	FIXING SCREW	1	064096	OG FITTING F1/4" - M1/4"	1
012128	VALVE ISO 1	1			
012132	SEEGER	2			
012510	BALL SEAT	2			
012514	DUMP VALVE MF 1/4" WITH RING NUT	1			
012515	FIXING BOLT	10			
012551	HEAD CONNECTING	2			
012552	O-RING, VITON	4			
013105	SEEGER	2			
013106	ELASTIC PIN	1			
013109	O.R. RING, SUCTION VALVE	2			
013111	BALL dia.19 IN NYLON	2			