

PART LIST AND DIAGRAM
Pneumatic Air Pump EDILSPRAY

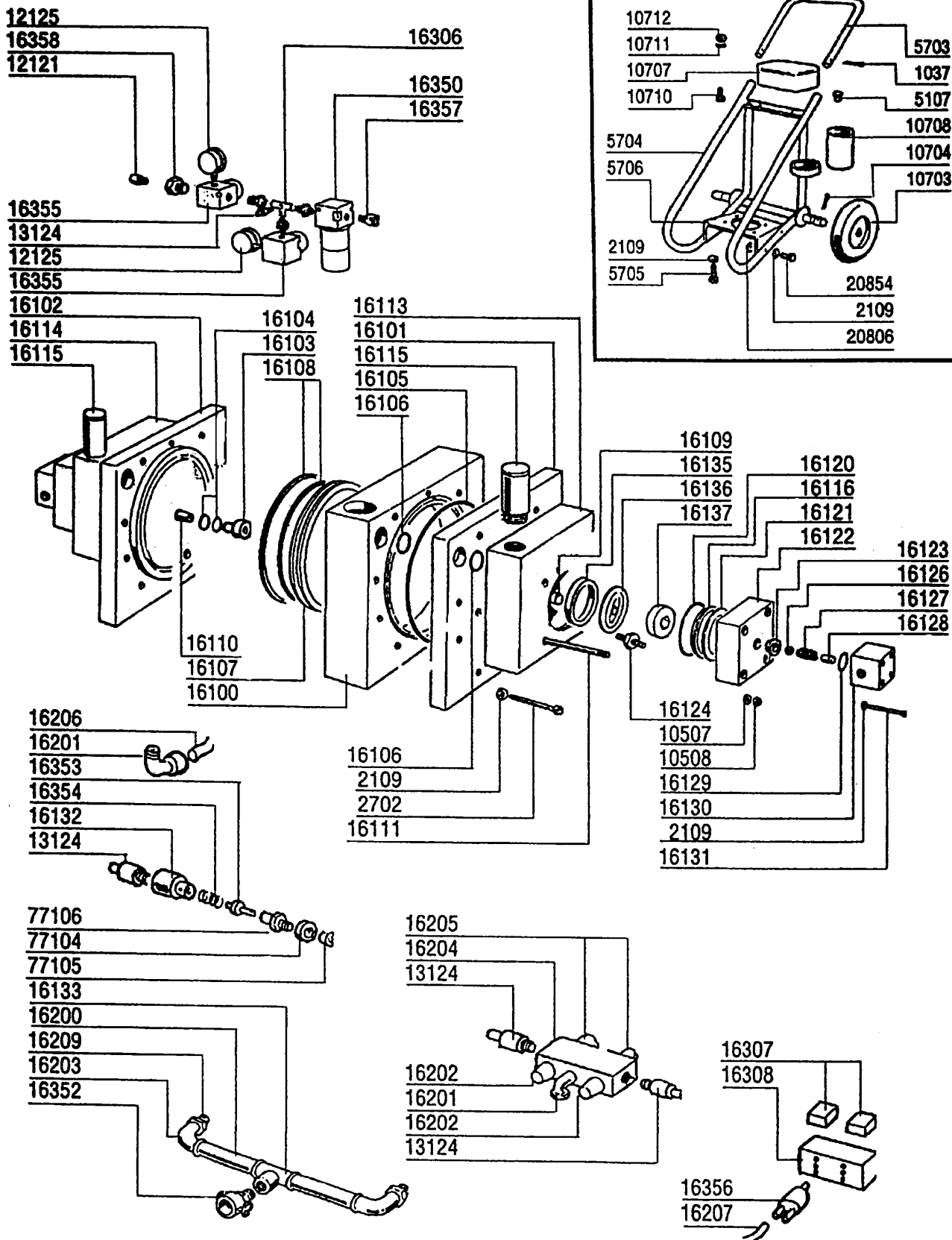

PART LIST AND DIAGRAM
Pneumatic Air Pump EDILSPRAY

| Ref. | Description | Q.ty | Ref. | Description | Q.ty |
|--------------|--|------|--------|----------------------------------|------|
| 16000 | <i>Pneumatic air pump EDILSPRAY</i> | | | | |
| 001037 | SPLIT PIN, UNIVERSAL TROLLEY | 1 | 016135 | DIAPHRAGM SEAL RING | 2 |
| 002109 | SCHNOOR WASHER | 32 | 016136 | DIAPHRAGM | 2 |
| 002702 | FIXING SCREW | 20 | 016137 | PISTON ROD | 2 |
| 005107 | PLUG dia.30 | 1 | 016200 | MANIFOLD TUBE 3/4" | 2 |
| 005703 | HANDLE, UNIVERSAL TROLLEY | 1 | 016201 | ELBOW 3/8" dia.12 FOR DECABON | 2 |
| 005704 | BODY, UNIVERSAL TROLLEY | 1 | 016202 | SILENCER | 2 |
| 005705 | FIXING BOLT | 1 | 016203 | ELBOW 3/4" FF | 2 |
| 005706 | PLATE, UNIVERSAL TROLLEY | 1 | 016205 | FITTING M3/8" dia.12 FOR DECABON | 2 |
| 010507 | WASHER | 8 | 016206 | HOSE DECABON dia.12 cm.70 | 1 |
| 010508 | NUT | 8 | 016207 | RILSAN HOSE dia.4 cm.30 | 2 |
| 010703 | WHEEL | 1 | 016209 | OG FITTING | 2 |
| 010704 | COTTER PIN | 2 | 016306 | "T" FITTING FFF1/2" | 1 |
| 010707 | TOOL BOX "TAIVER" | 1 | 016307 | YES UNIT | 2 |
| 010708 | SUCTION SYSTEM HOLDER | 1 | 016308 | CONTROL VALVE BASE | 1 |
| 010710 | FIXING BOLT | 2 | 016350 | CONDENSATE FILTER 1/2" | 1 |
| 010711 | WASHER | 2 | 016352 | RAPID ADAPTOR M3/4" | 1 |
| 010712 | FIXING NUT | 2 | 016353 | ROD | 2 |
| 012121 | ADAPTOR WITH RING NUT 1/4" | 1 | 016354 | ROD SPRING | 2 |
| 012125 | GAUGE | 2 | 016355 | PRESSURE REDUCER 1/2" | 2 |
| 013124 | RAPID ADAPTOR M1/8" dia.2-4 | 5 | 016356 | BY-PASS, THREEWAY dia.4 | 1 |
| 016100 | PUMP BODY EDILSPRAY | 1 | 016357 | RAPID ADAPTOR | 1 |
| 016101 | BODY FLANGE, RIGHT | 1 | 016358 | FITTING M1/2" F1/4" | 1 |
| 016102 | BODY FLANGE, LEFT | 1 | 020806 | BOLT | 1 |
| 016103 | BUSH | 2 | 020854 | BOLT | 1 |
| 016104 | LUBRORING | 2 | 077104 | SEAL SCREW, TEFLON | 2 |
| 016105 | OR RING | 2 | 077105 | PRESSURE WASHER | 2 |
| 016106 | OR RING | 4 | 077106 | SEAL SCREW | 2 |
| 016107 | PISTON, PUMP BODY | 1 | | | |
| 016108 | LUBRORING | 1 | | | |
| 016109 | PISTON ROD, LEFT | 1 | | | |
| 016110 | PISTON ROD, RIGHT | 1 | | | |
| 016111 | TIE-ROD | 8 | | | |
| 016113 | INTAKE CHAMBER, RIGHT | 1 | | | |
| 016114 | INTAKE CHAMBER, LEFT | 1 | | | |
| 016115 | ACCUMULATOR TUBE | 2 | | | |
| 016116 | S.S. RING | 2 | | | |
| 016120 | OR RING | 2 | | | |
| 016121 | SEAL RING | 2 | | | |
| 016122 | PRESSURE CHAMBER | 2 | | | |
| 016123 | BALL SEAT | 2 | | | |
| 016124 | PIN | 2 | | | |
| 016126 | BALL dia.25 IN S.S. | 2 | | | |
| 016127 | BALL SPRING | 2 | | | |
| 016128 | BALL INSERT | 2 | | | |
| 016129 | OR RING | 2 | | | |
| 016130 | HEAD BLOCK | 2 | | | |
| 016131 | FIXING BOLT | 8 | | | |
| 016132 | PISTON VALVE BLOCK | 2 | | | |
| 016133 | "T" FITTING FFF3/4" | 1 | | | |