

PART LIST AND DIAGRAM
Pneumatic Pump EXT - 13:1

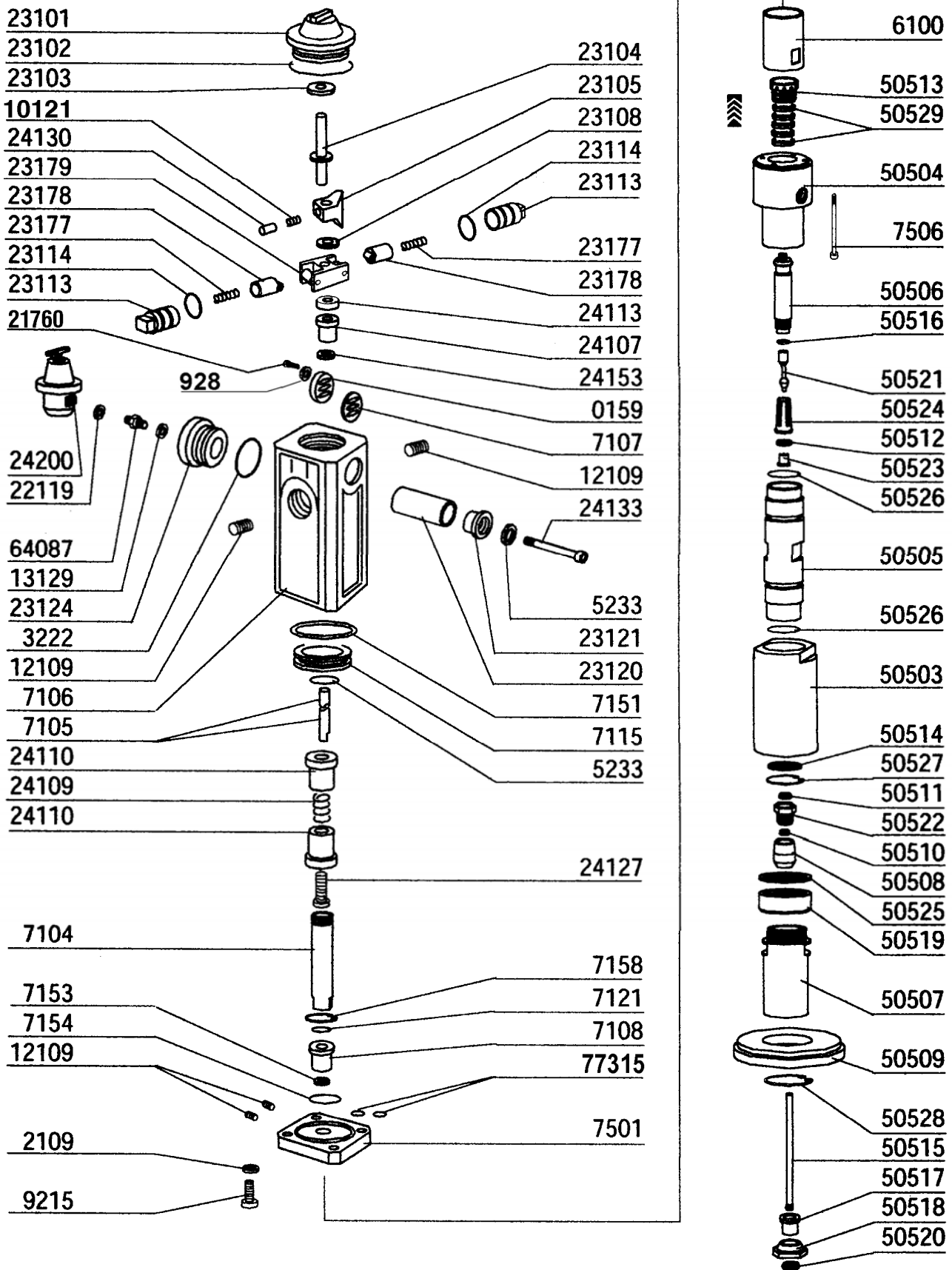

PART LIST AND DIAGRAM
Pneumatic Pump EXT - 13:1

Ref.	Description	Q.ty	Ref.	Description	Q.ty
50502	<i>Pneumatic pump EXT - 13:1</i>				
000159	CAP	1	050506	DELIVERY PISTON	1
000928	WASHER, SUCTION VALVE	1	050507	SUCTION BODY	1
002109	SCHNOOR WASHER	4	050508	SUCTION CONE	1
003222	O.R.	1	050509	FLANGE	1
005233	WASHER SCHNOOR	2	050510	GASKET	1
006100	AIR/PAINT SPACER	1	050511	GUIDE VALVE	1
007104	SHAFT, AIR MOTOR	1	050512	GASKET DOUBLE EFFECT	1
007105	ROD	1	050513	FIXING RING NUT	1
007106	AIR CONTROL VALVE BODY	1	050514	STROKE-STOP	1
007107	GASKET	1	050515	SUCTION STEM	1
007108	BUSH IN TEFLON	1	050516	WASHER	1
007115	AIR MOTOR PISTON	1	050517	BUSH	1
007121	RING C.S.C.	1	050518	CAP	1
007151	LUBRORING	1	050519	SUCTION SEAT	1
007153	O.R. RING	1	050520	NUT	1
007154	O.R. RING	1	050521	SPEAR VALVE FOR COMPRESSION	1
007158	SEEGER RING	1	050522	GASKET-PRESS	1
007501	AIR MOTOR FLANGE	1	050523	SEAT COMPRESSION VALVE	1
007506	FIXING SCREW	4	050524	SPACER	1
009215	FIXING SCREW	1	050525	SEAL GASKET	1
010121	SPRING	1	050526	OR	2
012109	CONICAL PLUG 1/8"	4	050527	SEEGER-RING	1
013129	COPPER GASKET 1/2"	1	050528	SEEGER-RING	1
021760	FIXING SCREW	2	050529	UPPER PACKING	1
022119	COPPER GASKET 3/8"	1	064087	NIPPLE M3/8" - M1/2" - S.S.	1
023101	COVER COMPLETE WITH BUSH	1	077315	OR RING	2
023102	GASKET	1			
023103	UPPER BUFFER	1			
023104	PILOT SHAFT	1			
023105	AIR CONTROL VALVE SUPPORT	1			
023108	WASHER	1			
023113	PISTON BODY	2			
023114	GASKET	2			
023120	SILENCER	1			
023121	SILENCER FIXING CAP	1			
023124	AIR CLUTCH FLANGE	1			
023177	SPRING FOR REVERSAL KIT	2			
023178	REVERSAL KIT PISTON	2			
023179	REVERSAL CONTROL SYSTEM	1			
024107	SELF-LUBRICATING BUSH	1			
024109	SPRING	1			
024110	UPPER GUIDE	2			
024113	LOWER BUFFER	1			
024127	BOLT	1			
024130	SPRING GUIDE	1			
024133	BOLT	1			
024153	LUBRORING	1			
024200	PRES. REDUCER 3/8" CPL WITH GAUGE	1			
050503	VALVES BODY	1			
050504	DELIVERY BODY	1			
050505	SLEEVE	1			