

PART LIST AND DIAGRAM
Pneumatic Pump EXT - 35:1

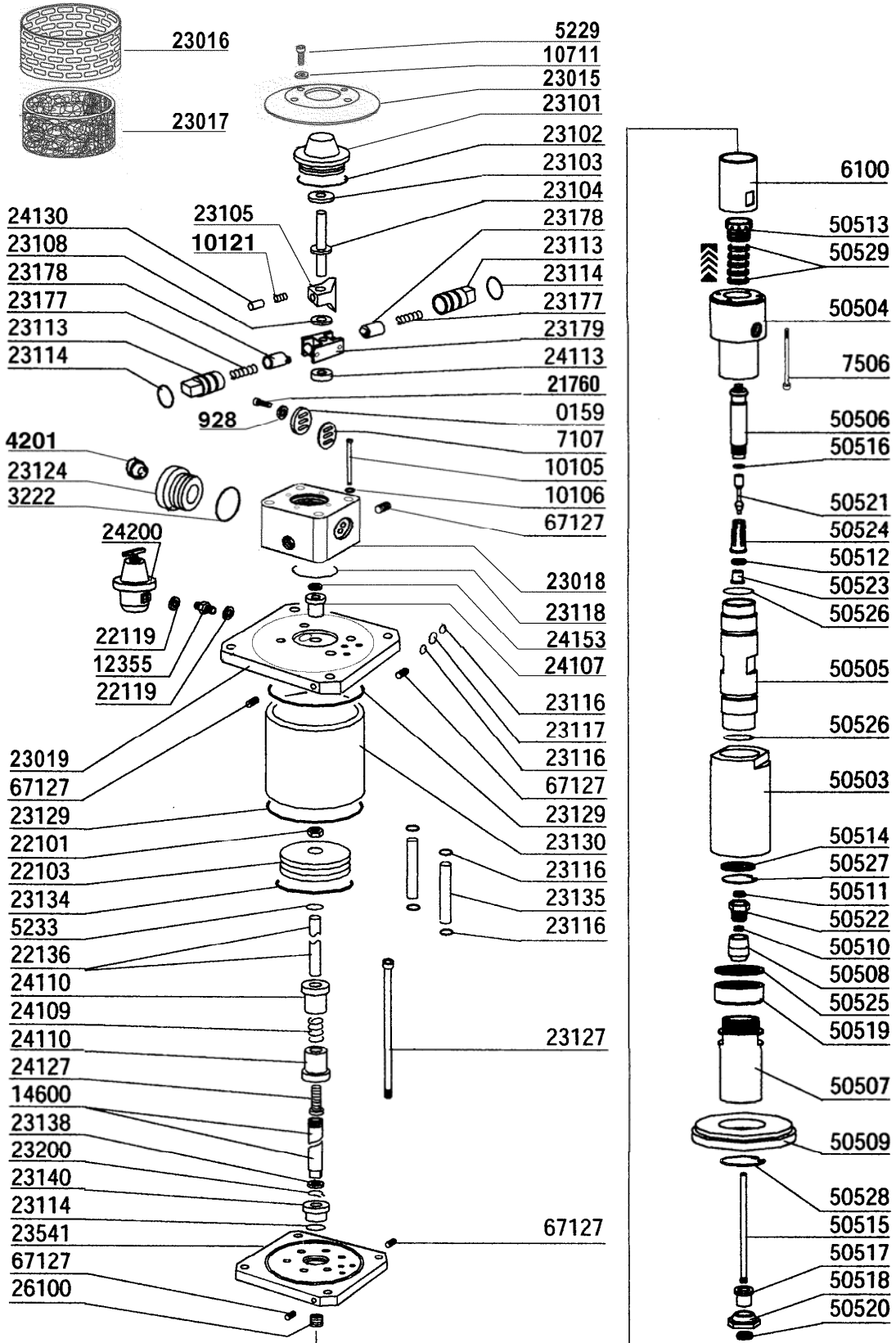

PART LIST AND DIAGRAM
Pneumatic Pump EXT - 35:1

Ref.	Description	Q.ty	Ref.	Description	Q.ty
26502	<i>Pneumatic pump EXT - 35:1</i>				
000159	CAP	1	024107	SELF-LUBRICATING BUSH	1
000928	WASHER, SUCTION VALVE	1	024109	SPRING	1
003222	O.R.	1	024110	UPPER GUIDE	2
004201	OIL LEVEL GLASS	1	024113	LOWER BUFFER	1
005229	FIXING BOLT	4	024127	BOLT	1
005233	WASHER SCHNOOR	1	024130	SPRING GUIDE	1
006100	AIR/PAINT SPACER	1	024153	LUBRORING	1
007107	GASKET	1	024200	PRES. REDUCER 3/8" CPL. WITH GAUGE	1
007506	FIXING SCREW	4	026100	CONNECTING BUSH	1
010105	BOLT	4	050503	VALVES BODY	1
010106	WASHER SCHNOOR	4	050504	DELIVERY BODY	1
010121	SPRING	1	050505	SLEEVE	1
010711	WASHER	4	050506	DELIVERY PISTON	1
012355	NIPPLE MM3/8"	1	050507	SUCTION BODY	1
014600	AIR PISTON SHAFT	1	050508	SUCTION CONE	1
021760	FIXING SCREW	2	050509	FLANGE	1
022101	NUT	1	050510	GASKET	1
022103	AIR MOTOR PISTON	1	050511	GUIDE VALVE	1
022119	COPPER GASKET 3/8"	2	050512	GASKET DOUBLE EFFECT	1
022136	PILOT VALVE ROD	1	050513	FIXING RING NUT	1
023015	COVER, MOTOR SILENCER	1	050514	STROKE-STOP	1
023016	FILTER NET	1	050515	SUCTION STEM	1
023017	SILENCER	1	050516	WASHER	1
023018	AIR CONTROL VALVE BODY	1	050517	BUSH	1
023019	UPPER FLANGE	1	050518	CAP	1
023101	COVER COMPLETE WITH BUSH	1	050519	SUCTION SEAT	1
023102	GASKET	1	050520	NUT	1
023103	UPPER BUFFER	1	050521	SPEAR VALVE FOR COMPRESSION	1
023104	PILOT SHAFT	1	050522	GASKET-PRESS	1
023105	AIR CONTROL VALVE SUPPORT	1	050523	SEAT COMPRESSION VALVE	1
023108	WASHER	1	050524	SPACER	1
023113	PISTON BODY	2	050525	SEAL GASKET	1
023114	GASKET	3	050526	OR	2
023116	GASKET	6	050527	SEEGER-RING	1
023117	GASKET	1	050528	SEEGER-RING	1
023118	GASKET	1	050529	UPPER PACKING	1
023124	AIR CLUTCH FLANGE	1	067127	CONICAL PLUG 1/4"	5
023127	SOCKET SCREW	4	077315	OUTER OR, AIR SEAL	2
023129	GASKET	2			
023130	AIR CYLINDER	1			
023134	LUBRORING	1			
023135	AIR CONNECTION TUBE	2			
023138	SEEGER	1			
023140	LOWER FLANGE BUSH	1			
023177	SPRING FOR REVERSAL KIT	2			
023178	REVERSAL KIT PISTON	2			
023179	REVERSAL CONTROL SYSTEM	1			
023200	RING	1			
023541	LOWER FLANGE	1			