

PART LIST AND DIAGRAM  
Electric Diaphragm Airless Pump GOLD 11000

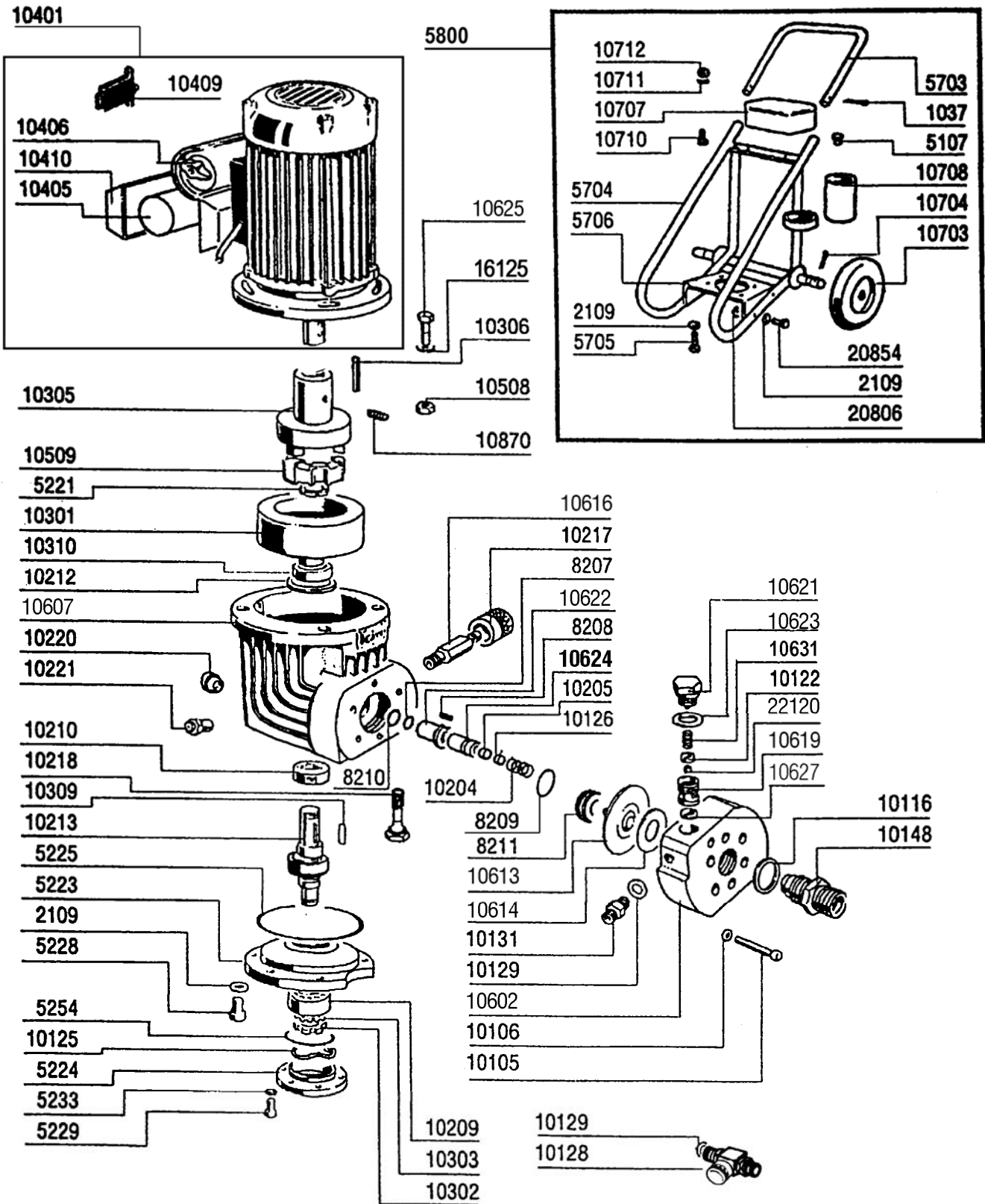

**PART LIST AND DIAGRAM**  
**Electric Diaphragm Airless Pump GOLD 11000**

Ref.	Description	Q.ty	Ref.	Description	Q.ty
<b>10600</b>	<b>Electric Diaphragm Airless pump GOLD 11000 - S.S.</b>				
002109	SCHNOOR WASHER	6	010624	PISTON	1
005221	RING NUT	1	010625	FIXING BOLT	1
005223	FLANGE	1	010627****	BALL SEAT GASKET	1
005224	FLANGE COVER	1	010631****	COMPRESSION SPRING	1
005228	FLANGE SCREW	6	010870	FIXING SCREW	1
005229	FIXING BOLT	6	016125	WASHER	4
005233	WASHER SCHNOOR	6	022120****	BALL dia.14, T.C.	1
005254	O.R. GASKET	1			
008207	PRESSURE GASKET, TEFLON	1	<b>005800</b>	<b>UNIVERSAL TROLLEY KIT:</b>	<b>1</b>
008208	SLEEVE PIN	1	001037	SPLIT PIN, UNIVERSAL TROLLEY	2
008209	WASHER	1	002109	SCHNOOR WASHER	4
008210	O.R.	1	005107	PLUG dia.30	2
008211	FIXING RING NUT	1	005703	HANDLE, UNIVERSAL TROLLEY	1
010105	BOLT	6	005704	BODY, UNIVERSAL TROLLEY	1
010106	WASHER SCHNOOR	6	005705	FIXING BOLT	1
010116**	SUCTION VALVE GASKET	1	005706	PLATE, UNIVERSAL TROLLEY	1
010122****	SUPPORT RING, TEFLON	1	010703	WHEEL	2
010125	SPRING	1	010704	COTTER PIN	2
010126	WASHER	1	010707	TOOL BOX "TAIVER"	1
010128*	DUMP VALVE, S.S.	1	010708	SUCTION SYSTEM HOLDER	1
010129*	COPPER SEAL	1	010710	FIXING BOLT	2
010131	NIPPLE M1/4" - M16x1,5 - S.S.	1	010711	WASHER	2
010148**	SUCTION VALVE	1	010712	FIXING NUT	2
010204	PISTON SPRING	1	020806	BOLT	4
010205	TEFLON RING	1	020854	BOLT	4
010209	LOWER BEARING	2			
010210	UPPER BEARING	1			
010212	OIL SEAL	1			
010213	CAM'S SHAFT COMPLETE	1	<b>Spare parts suggested:</b>		
010217	KNOB, REGULATING VALVE	1	10328	DUMP VALVE KIT, S.S. (*)	
010218	OIL FILTER COMPLETE	1	10348	SUCTION VALVE KIT (**)	
010220	OIL LEVEL GLASS	1	10603	DIAPHRAGM/SUPPORT KIT (***)	
010221	PLUG VENT	1	10648	COMPRESSION VALVE KIT (****)	
010301	FLYWHEEL JOINT	1			
010302	FIXING RING NUT	1			
010303	SEAL	1			
010305	MOTOR JOINT	1			
010306	MOTOR SHAFT KEY	1			
010309	FLYWHEEL JOINT KEY	1			
010310	SCRAPER RING	1			
010401	ELECTRIC MOTOR 220 Volt/50 Hz - HP3	1			
010405	CONDENSER 50 MF	1			
010406	SWITCH COMPLETE 220 Volt	1			
010409	MOTOR PROTECTOR 13 A.	1			
010410	CONDENSER BOX	1			
010508	NUT	1			
010509	CLUTCH INSERT	1			
010602	HEAD BLOCK, S.S. (bare)	1			
010607	HYDRAULIC BODY	1			
010613***	DIAPHRAGM	1			
010614***	DIAPHRAGM SUPPORT	1			
010616	PRESSURE REGULATOR	1			
010619****	BALL SEAT CPL.	1			
010621****	COMPRESSION VALVE PLUG	1			
010622	PISTON SLEEVE	1			
010623****	COPPER GASKET	1			