

PART LIST AND DIAGRAM  
**Electric Diaphragm Airless Pump GOLD 22000**

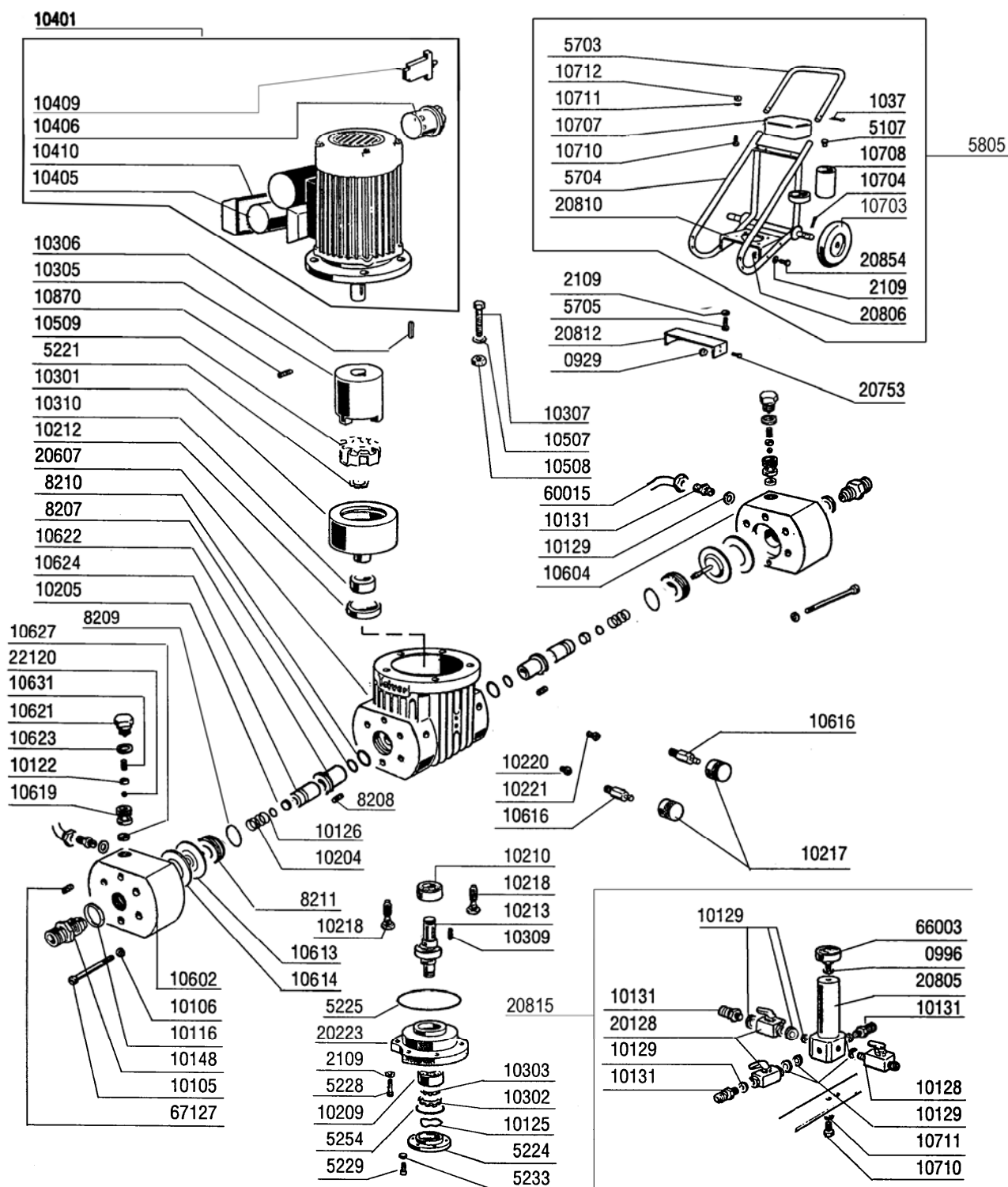

**PART LIST AND DIAGRAM**  
**Electric Diaphragm Airless Pump GOLD 22000**

Ref.	Description	Q.ty	Ref.	Description	Q.ty
<b>20004</b>	<b>Electric Diaphragm Airless pump GOLD 22000 - S.S.</b>				
000929	SELF LOCKING NUT	1	010405	CONDENSER 50 MF	1
000996	TEFLON RING	1	010406	SWITCH COMPLETE 220 Volt	1
001037	SPLIT PIN, UNIVERSAL TROLLEY	2	010409	MOTOR PROTECTOR 13 A.	1
002109	SCHNOOR WASHER	6	010410	CONDENSER BOX	1
005107	PLUG dia.30	2	010507	WASHER	4
005221	RING NUT	1	010508	NUT	4
005224	FLANGE COVER	1	010509	CLUTCH INSERT	1
005225	O.R.	1	010602	HEAD BLOCK, S.S. (bare)	1
005228	FLANGE SCREW	6	010604	HEAD BLOCK, RIGHT	1
005229	FIXING BOLT	6	010613***	DIAPHRAGM	1
005233	WASHER SCHNOOR	6	010614***	DIAPHRAGM SUPPORT	2
005254	O.R. GASKET	1	010616	PRESSURE REGULATOR	2
005703	HANDLE, UNIVERSAL TROLLEY	1	010619****	BALL SEAT CPL.	2
005704	BODY, UNIVERSAL TROLLEY	1	010621****	COMPRESSION VALVE PLUG	2
005705	FIXING BOLT	4	010622	PISTON SLEEVE	2
005815	WHEEL	2	010623****	COPPER GASKET	2
008207	PRESSURE GASKET, TEFLON	2	010624	PISTON	2
008208	SLEEVE PIN	2	010627****	BALL SEAT GASKET	2
008209	WASHER	1	010631****	COMPRESSION SPRING	2
008210	O.R.	2	010704	COTTER PIN	2
008211	FIXING RING NUT	2	010707	TOOL BOX "TAIVER"	1
010105	BOLT	12	010708	SUCTION SYSTEM HOLDER	1
010106	WASHER SCHNOOR	12	010710	FIXING BOLT	4
010116**	SUCTION VALVE GASKET	2	010711	WASHER	4
010122****	SUPPORT RING, TEFLON	2	010712	FIXING NUT	2
010125	SPRING	1	010870	FIXING SCREW	1
010126	WASHER	2	020128	DUMP VALVE FF 1/4" - S.S.	2
010128*	DUMP VALVE, S.S.	1	020223	BEARING FLANGE	1
010129*	COPPER SEAL	2	020607	HYDRAULIC HOUSING	1
010131	NIPPLE M1/4" - M16x1,5 - S.S.	2	020753	FIXING BOLT	4
010148**	SUCTION VALVE	2	020805	LINE FILTER, DOUBLE INLET	1
010204	PISTON SPRING	2	020806	BOLT	4
010205	TEFLON RING	2	020810	PLATE	1
010209	LOWER BEARING	1	020812	FILTER SUPPORT	1
010210	UPPER BEARING	1	020854	BOLT	4
010212	OIL SEAL	1	022120****	BALL dia.14, T.C.	2
010213	CAM'S SHAFT COMPLETE	1	060015	H.P. HOSE dia.10 - cm.70	2
010217	KNOB, REGULATING VALVE	2	066003	PRESSURE GAUGE 400 BAR "TAIVER"	1
010218	OIL FILTER COMPLETE	1	067127	CONICAL PLUG 1/4"	2
010220	OIL LEVEL GLASS	1			
010221	PLUG VENT	1			
010301	FLYWHEEL JOINT	1			
010302	FIXING RING NUT	1			
010303	SEAL	1			
010305	MOTOR JOINT	1			
010306	MOTOR SHAFT KEY	1			
010307	FIXING BOLT	4			
010309	FLYWHEEL JOINT KEY	1			
010310	SCRAPER RING	1			
010401	ELECTRIC MOTOR 220 Volt/50 Hz - HP3	1			
010405					
<b>Spare parts suggested:</b>					
			10328	DUMP VALVE KIT,S.S. (* q.ty 1)	
			10348	SUCTION VALVE KIT (** q.ty 1)	
			10603	DIAPHRAGM/SUPPORT KIT (***) q.ty 1)	
			10648	COMPRESSION VALVE KIT (**** q.ty 1)	