

PART LIST AND DIAGRAM
Double diaphragm pump BOXER 24

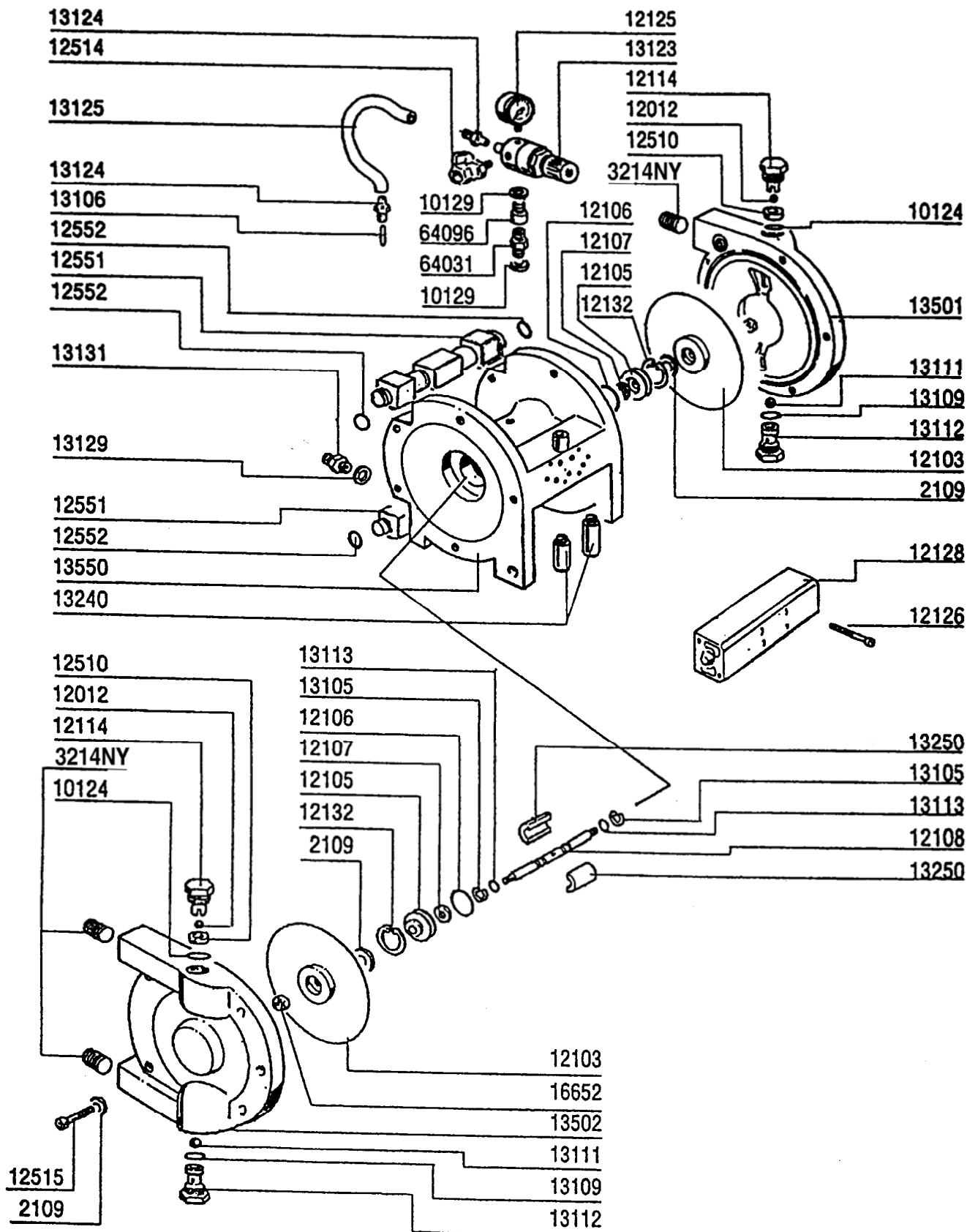

PART LIST AND DIAGRAM
Double diaphragm pump BOXER 24

Ref.	Description	Q.ty	Ref.	Description	Q.ty
13000	Double diaphragm pump BOXER 24				
002109	SCHNOOR WASHER	12	013112	SUCTION VALVE BODY	2
003130	INLET SEAL	1	013113	O.R. RING	2
003214	PLUG	4	013123	PRESSURE REDUCER 1/4"	1
010124	BALL SEAT GASKET	2	013124	RAPID ADAPTOR M1/8" dia.2-4	1
010129	COPPER SEAL	2	013125	RILSAN HOSE dia.4 cm.10	1
012011	BALL dia.11, S.S.	1	013129	COPPER GASKET 1/2"	1
012012	BALL dia.11, NYLON	2	013131	NIPPLE M 1/2" M 3/4" - S.S.	1
012103	DIAPHRAGM	2	013240	SILENCER 1/4"	2
012105	SHAFT GUIDE	2	013250	HALF BEARING	2
012106	O.R. RING	2	013501	PLASTIC HEAD, RIGHT	1
012107	SEAL RING	2	013502	PLASTIC HEAD, LEFT	1
012108	SHAFT	1	013550	PUMP HOUSING	1
012114	COMPRESSION VALVE PLUG	2	016652	SELF LOCKING NUT M8	2
012125	GAUGE BOXER	1	064031	NIPPLE S.S. MM1/4"	1
012126	FIXING SCREW	1	064096	OG FITTING F1/4" - M1/4"	1
012128	VALVE ISO 1	1			
012132	SEEGER	2			
012510	BALL SEAT	2			
012514	DUMP VALVE MF 1/4" WITH RING NUT	1			
012515	FIXING BOLT	10			
012551	HEAD CONNECTING	2			
012552	O-RING, VITON	4			
013105	SEEGER	2			
013106	ELASTIC PIN	1			
013109	O.R. RING, SUCTION VALVE	2			
013111	BALL dia.19 IN NYLON	2			